

Pompa Semiassiale

Sollevamento di acqua pulita per pozzi da 8"
 • Max. contenuto di solidi (limo): 50g/m³

Funzionamento:

• Hz: 50 • 2 poli • γ:1

Materiali:

Girante semiassiale:

Corpo di stadio:

Albero:

Valvola di ritegno:

Griglia d'aspirazione:

Viteria:

DX8

(acqua potabile)

Ghisa, AISI 316, Bronzo

Ghisa

Acciaio Inox (AISI 420)

Ghisa

Acciaio Inox (AISI 304)

Acciaio Inox (AISI 304)

DX8

(acqua di mare)

Bronzo senza zinco

Bronzo senza zinco

Acciaio Inox (Duplex)

Bronzo senza zinco

Acciaio Inox (AISI 304)

Acciaio Inox (AISI 316)

A richiesta si possono fornire pompe in Acciaio Inox fuso.

Senso di rotazione:

Antiorario (visto dalla bocca di mandata)

Mixed-Flow Pump

Clean water lifting for wells 8"
 • Max. content of solids (silt): 50g/m³

Operation:

• Hz: 50 • 2 poles • γ:1

Materials:

Mixed flow impeller:

Pump body:

Shaft:

Non-return valve:

Suction strainer:

Nuts, bolts and screws

DX8

(drinkwater)

Cast-iron, AISI 316, Bronze

Cast-iron

Stainless steel (AISI 420)

Cast-iron

Stainless steel (AISI 304)

Stainless steel (AISI 304)

DX8

(seawater)

Zinc free Bronze

Zinc free Bronze

Stainless steel (Duplex)

Zinc free Bronze

Stainless steel (AISI 304)

Stainless steel (AISI 316)

Direction of rotation:

Counter-Clockwise (facing delivery side)

Tipo / Type	Motore / Motor		Q = Portata / Capacity										A V400
			L/sec	0	8,3	11,1	13,9	16,7	19,4	22,2	25	27,8	
			L/min	0	500	667	833	1000	1167	1333	1500	1667	
	HP	kW	m ³ /h	0	30	40	50	60	70	80	90	100	
DX8E1	7,5	5,5	H (m)	24	21	20	18	17	16	14	12	9	
DX8E2	12,5	9,2		48	41	39	37	34	31	28	24	18	
DX8E3	17,5	13		74	63	60	56	52	48	42	36	28	
DX8E4	25	18,5		100	85	81	76	70	64	57	49	38	
DX8E5	30	22		126	108	102	96	89	81	72	61	48	
DX8E6	35	26		153	131	124	116	107	98	88	74	58	
DX8E7	40	30		179	153	144	135	125	113	100	85	67	
DX8E8	50	37		204	174	165	154	143	131	117	99	77	
DX8E9	60	45		230	196	185	174	161	148	131	112	86	
DX8E10	60	45		255	218	206	193	179	164	146	124	96	
DX8E11	75	55		281	240	227	212	197	180	161	136	106	
DX8E12	75	55		306	262	247	232	215	197	175	149	115	
DX8E13	85	63		332	283	268	251	233	213	190	161	125	
DX8E14	85	63		357	305	288	270	251	230	204	174	134	
DX8E15	100	75		383	327	309	290	269	246	219	186	144	

Poles: 2
 Hz: 50
 Q (m³/h): 30-100
 H(m): 9-327
 kW: 5,5 - 75

□ Tolleranze / Tolerances: ISO 9906 - Annex 2

■ Corrente massima assorbita (motore) a 400 V /
Max absorbed current (motor) at 400 V

⚡ Min. recommended head of water above pump suction : m

☆ Le potenze indicate sono valide per accoppiamenti standard.
Su specifica richiesta possono essere impiegati motori di potenza superiore. /
The shown motor ratings are for standard couplings.
Motors with more or less ratings can be utilized to client specific request.

* I dati qui riportati possono essere modificati senza preavviso. /
The above data may change without notice.

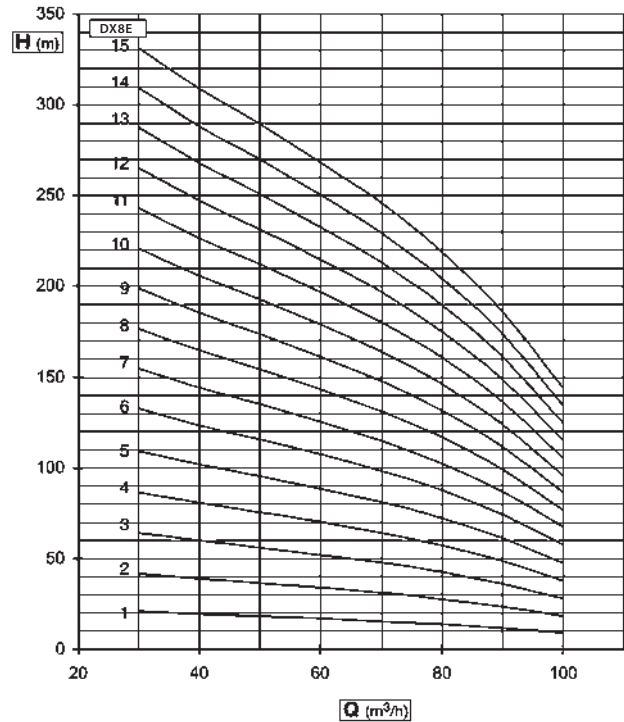
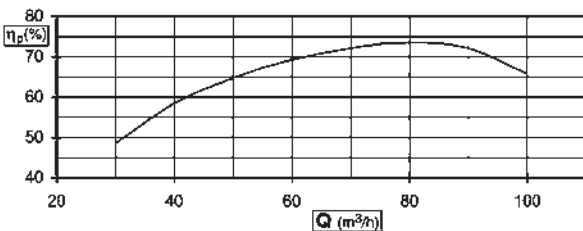

Tipo / Type	Motore / Motor		Q = Portata / Capacity											
			L/sec	0	11,1	13,9	16,7	19,4	22,2	25	27,8	30,6	33,3	A
			L/min	0	667	833	1000	1167	1333	1500	1667	1833	2000	V400
	HP	kW	m ³ /h	0	40	50	60	70	80	90	100	110	120	
DX8G1	7,5	5,5	H (m)	26	21	20	19	18	16	15	14	12	9	13
DX8G2	15	11		51	42	40	38	35	33	30	27	23	18	25
DX8G3	25	18,5		79	65	62	58	54	50	47	42	36	28	38
DX8G4	30	22		106	88	83	78	73	68	63	56	48	38	45
DX8G5	35	26		134	111	105	99	92	86	79	71	61	48	53
DX8G6	50	37		162	134	127	119	112	104	96	86	74	58	81
DX8G7	50	37		189	156	148	139	130	121	112	101	86	68	81
DX8G8	60	45		216	179	170	159	149	138	128	115	98	78	89
DX8G9	75	55		243	201	191	179	167	156	144	130	111	87	108
DX8G10	75	55		270	224	212	199	186	173	160	144	123	97	108
DX8G11	85	63		297	246	233	219	205	190	176	158	135	107	122
DX8G12	85	63		324	268	254	239	223	208	192	173	148	116	122
DX8G13	100	75		351	291	276	259	242	225	208	187	160	126	145
DX8G14	100	75		378	313	297	279	260	242	224	202	172	136	145

Poles: 2
 Hz: 50
 Q (m³/h): 40-120
 H(m): 9-313
 kW: 5,5 - 75

□ Tolleranze / Tolerances: ISO 9906 - Annex 2

■ Corrente massima assorbita (motore) a 400 V /
Max absorbed current (motor) at 400 V

⚡ Min. recommended head of water above pump suction : m

☆ Le potenze indicate sono valide per accoppiamenti standard.
Su specifica richiesta possono essere impiegati motori di potenza superiore. /
The shown motor ratings are for standard couplings.
Motors which more or less ratings can be utilized to client specific request.

* I dati qui riportati possono essere modificati senza preavviso. /
The above data may change without notice.

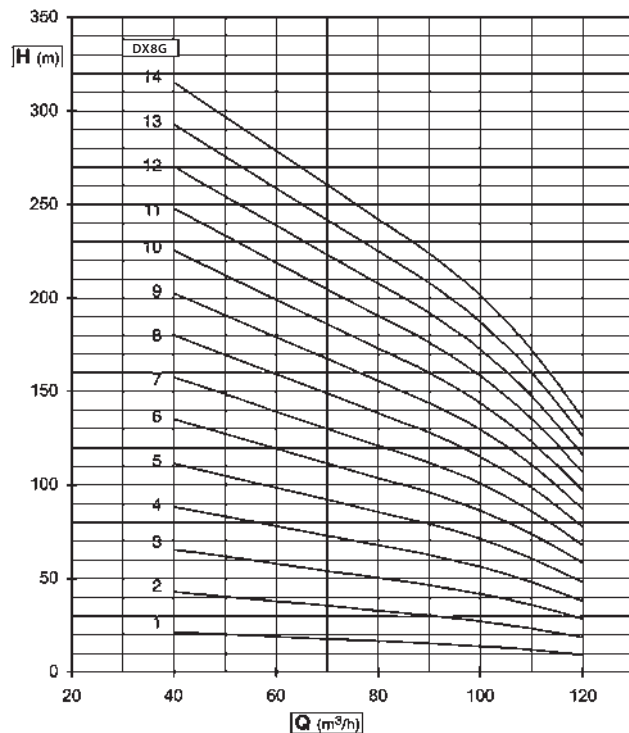
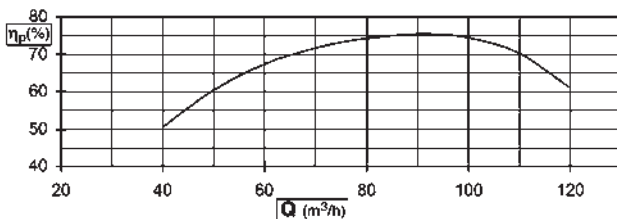

Tipo / Type	Motore / Motor		Q = Portata / Capacity											
			L/sec	0	16,7	19,4	22,2	25	27,8	30,6	33,3	36,1	38,9	A V400
			L/min	0	1000	1167	1333	1500	1667	1833	2000	2167	2333	
HP	kW	m ³ /h	0	60	70	80	90	100	110	120	130	140		
DX8H1	10	7,5	H (m)	24	20	19	18	17	16	15	14	12	11	18
DX8H2	17,5	13		49	40	38	36	34	23	30	28	25	22	29
DX8H3	30	22		74	61	58	55	52	49	46	42	38	33	45
DX8H4	35	26		100	82	78	74	71	67	62	57	51	45	53
DX8H5	50	37		127	104	99	94	89	84	79	72	65	56	81
DX8H6	60	45		154	126	120	113	108	102	95	88	79	68	89
DX8H7	60	45		179	147	140	132	126	119	111	102	92	80	89
DX8H8	75	55		205	168	160	151	144	136	127	117	105	91	108
DX8H9	85	63		230	189	180	170	162	153	143	131	118	103	122
DX8H10	100	75		256	210	200	189	180	170	159	146	131	114	145
DX8H11	100	75		282	231	220	208	198	187	175	161	144	125	145
DX8H12	125	92		307	252	250	227	216	204	191	175	157	137	178
DX8H13	125	92		333	273	260	246	234	221	207	190	170	148	178
DX8H14	125	92		358	294	280	265	252	238	223	204	183	160	178
DX8H15	150	110		384	315	300	284	270	255	239	219	197	171	217

Poles: 2
 Hz: 50
 Q (m³/h): 60-140
 H(m): 11-315
 kW: 7,5 - 110

□ Tolleranze / Tolerances: ISO 9906 - Annex 2

■ Corrente massima assorbita (motore) a 400 V /
Max absorbed current (motor) at 400 V

⚡ Min. recommended head of water above pump suction : m

☆ Le potenze indicate sono valide per accoppiamenti standard.
Su specifica richiesta possono essere impiegati motori di potenza superiore. /
The shown motor ratings are for standard couplings.
Motors with more or less ratings can be utilized to client specific request.

* I dati qui riportati possono essere modificati senza preavviso. /
The above data may change without notice.

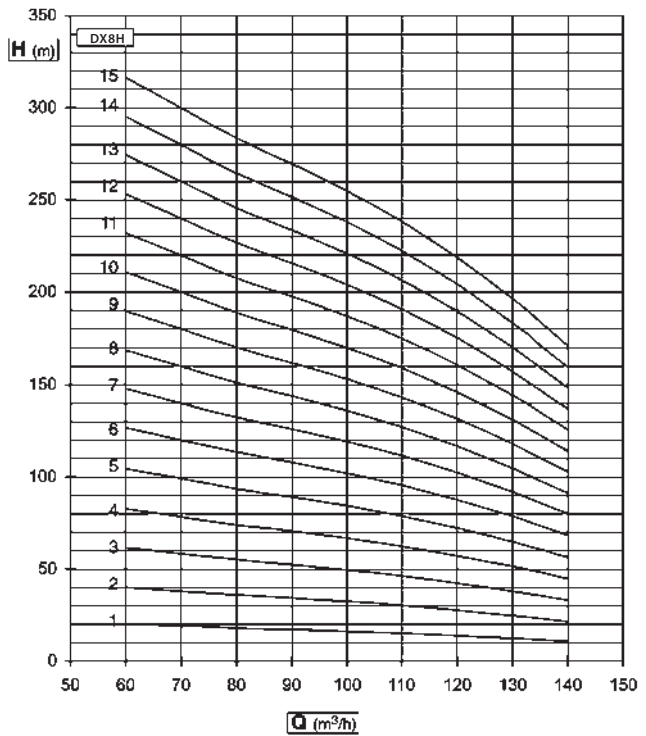
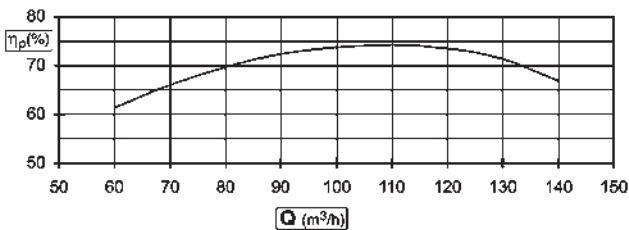

Tipo / Type	Motore / Motor		Q = Portata / Capacity											
			L/sec	0	19,4	25	27,8	30,6	33,3	36,1	38,9	41,7	44,4	A
			L/min	0	1167	1500	1667	1833	2000	2167	2333	2500	2667	V400
	HP	kW	m ³ /h	0	70	90	100	110	120	130	140	150	160	
DX8L1	12,5	9,2	H (m)	25	20	19	18	17	17	16	15	13	12	21
DX8L2	25	18,5		50	41	38	38	35	33	32	29	27	24	38
DX8L3	35	26		77	63	58	56	54	51	49	45	41	36	53
DX8L4	50	37		103	84	78	75	72	69	65	60	55	49	81
DX8L5	60	45		131	106	99	95	91	87	83	76	69	61	89
DX8L6	75	55		158	129	119	115	110	106	100	92	84	74	108
DX8L7	85	63		185	151	139	134	129	123	117	108	98	87	122
DX8L8	100	75		211	172	159	154	147	141	134	123	112	99	145
DX8L9	100	75		238	194	179	173	166	158	150	139	126	112	145
DX8L10	125	92		264	215	199	192	184	176	167	154	140	124	178
DX8L11	125	92		290	237	219	211	202	194	184	169	154	136	178
DX8L12	150	110		317	258	239	230	221	211	200	185	168	149	212
DX8L13	150	110		343	280	259	250	239	229	217	200	182	161	212
DX8L14 •	180	132		370	301	279	269	258	246	234	216	196	174	258

Poles: 2
 Hz: 50
 Q (m³/h): 70-160
 H(m): 12-301
 kW: 9,2 - 132

• per pozzi da 10"/ for 10" wells

□ Tolleranze / Tolerances: ISO 9906 - Annex 2

■ Corrente massima assorbita (motore) a 400 V /
Max absorbed current (motor) at 400 V

⚡ Min. recommended head of water above pump suction : m

☆ Le potenze indicate sono valide per accoppiamenti standard.
Su specifica richiesta possono essere impiegati motori di potenza superiore. /
The shown motor ratings are for standard couplings.
Motors which more or less ratings can be utilized to client specific request.

* I dati qui riportati possono essere modificati senza preavviso. /
The above data may change without notice.

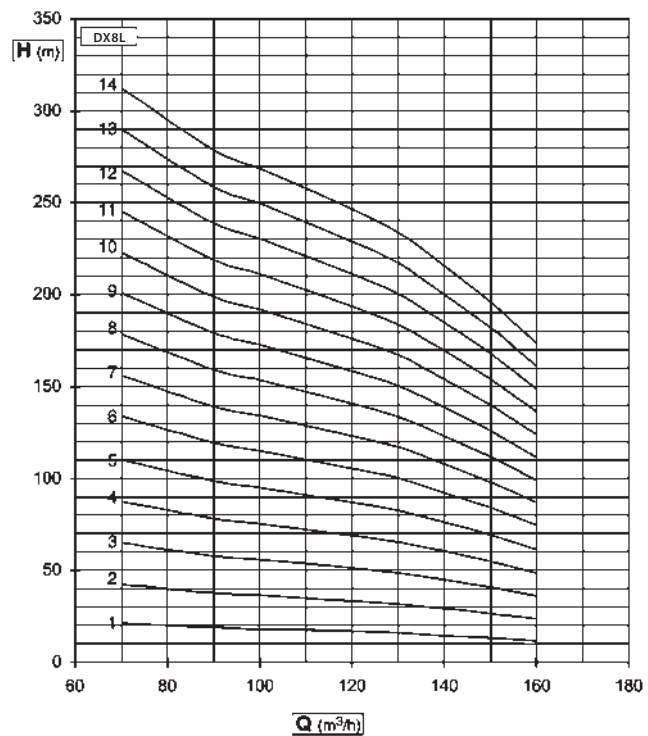
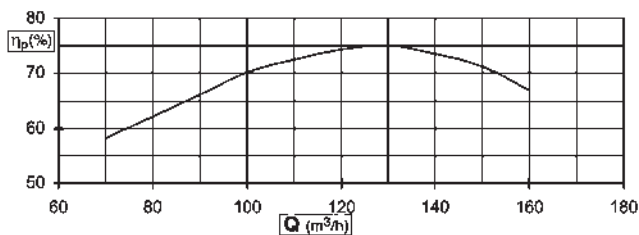

Dimensioni d'ingombro / Overall dimensions encombrement

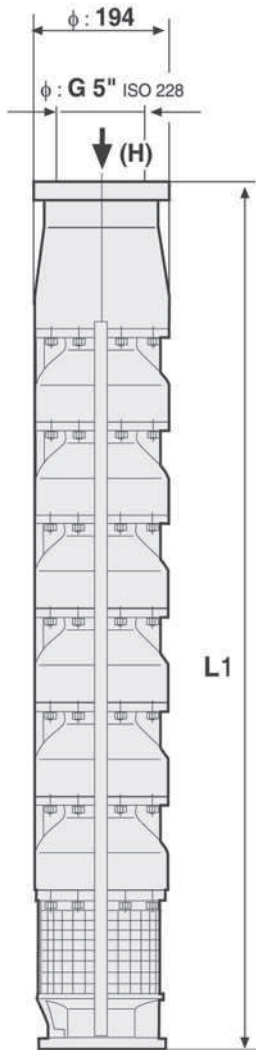

Pump Flange (H)

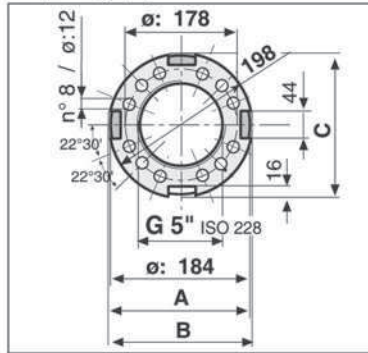

Pompa Pump Pompe	DOL		Y/D	
	A	B	C	
	mm	mm	mm	
DX8... + 6"	194	194	194	
DX8... + 8"	196	200	200	
DX8... + 10"	237	237	237	

Pompa / Pump	Motore/Motor 6"		Motore/Motor 8"		Motore/Motor 10"	
	L1 mm	Weight kg	L1 mm	Weight kg	L1 mm	Weight kg
DX8..1	604	42				
DX8..2	736	52				
DX8..3	868	62				
DX8..4	1000	72				
DX8..5	1132	82				
DX8..6	1264	92	1292	95		
DX8..7	1396	102	1424	105	1424	108
DX8..8	1528	112	1556	115	1556	118
DX8..9	1660	122	1688	125	1688	128
DX8..10	1792	132	1820	135	1820	138
DX8..11			1952	145	1952	148
DX8..12			2084	155	2084	158
DX8..13			2216	165	2216	168
DX8..14			2348	175	2348	178
DX8..15			2480	185	2480	188